



BC#

15131

**3500 G1 EXECUTIVE SHUTTLE FLOOR PLAN**

Option #1

Seating Configurations

{13 Pass + Dr & Cp} (13) - 18" Single Seats

Choose One

XXXXXXX

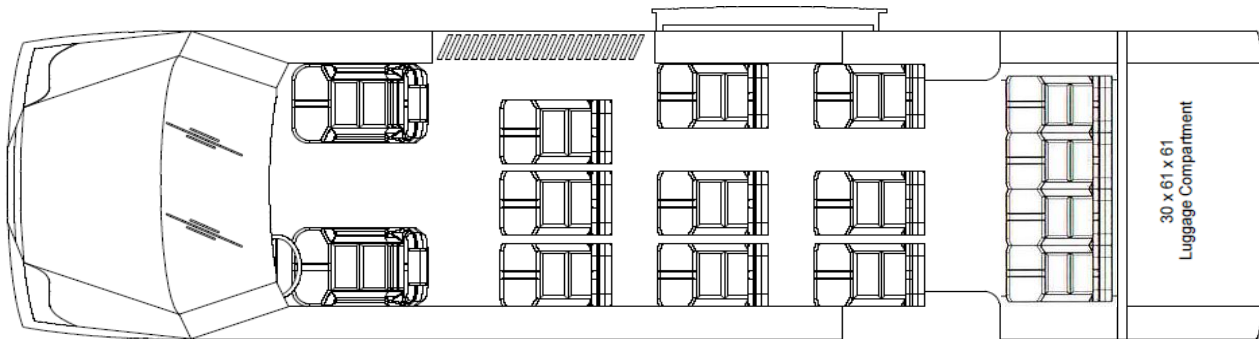

**CUSTOM FLOORPLANS AVAILABLE**

**G1 EXECUTIVE SHUTTLE STANDARD FEATURES**

- Black Gerfloor Non-Skid Sound Dampening Coach Flooring or Black Carpet
- Side Walls and Door with Vinyl Upper and Lower Carpet Kick Panels
- Automotive Headliner Rolled Valance with 6" Gloss Black Wood Accent with BLUE Indirect back Lighting
- Vinyl Wrapped Pillars with 2" Black Gloss Wood Inserts Blue Led Edge Lighting
- Carpet Kick panels on lower rear walls
- Insulation Package Sidewalls, Ceiling, and Doors
- (6) Charging Stations (One at Each Seat Position) -- Each include a 12v Outlet and USB Port
- (6) LED Floor Lights one at each seat position
- (7) Magnified LED Puck Lights with Chrome Ring
- (4) Rear 6.5" 2-way Speakers with tweeter connected to Dash Stereo
- Front Touch Screen Double Din Stereo with DVD/ CD/ IPOD / AMFM / MP3 / USB/ BT
- (1) Relay Board with 3-Switch System for Indirect, Floor, and Ceiling Lighting
- (2) Powder Coat Flat Black Grab Rails at Left and Right of Entrance Door
- Rear 30" x 61" X 61" Luggage Area Lighted, with Gray Automotive Trunk Liner Walls and 2 Retractable Coat Hangers
- Full Rear Partition Wall with Air Return Vents
- 46,000 BTU Air/Heat system with 2nd Compressor / 3 Fan Condenser / Free Blow Evaporator / Manual Driver Dash Control
- Black Aluminum Running Boards
- Emergency Egress Driver Side Escape Window ( Mercedes Factory Part)

**Chassis**      **3500 Mercedes Sprinter 170 Extended**  
**2016**          **Jet Black Exterior**  
 6 Cylinder 3.0ltr Diesel Engine with 20 MPG  
 Dual Rear Wheels with Chrome Wheel Simulator Package  
 Power Mirrors / Cruise / PW / PL  
 Mercedes Badging Package with Chrome Trim Grill  
 2nd Factory Battery  
 Factory High Idle  
 Windows Package with Limo Tint  
 Aux Bracket for 2nd Compressor  
 Driver/Copilot Seats – OEM Black Fabric  
 Premium Package  
 Single Manual Sliding Door  
  
 FACTORY GVWR 3500: **11,030**

**G1 EXECUTIVE SHUTTLE INTERIOR OPTIONS**

**Front Cab**

	<u>QTY</u>
Front Seat Recovers Ultra Soft Touch Material	1
5-PC Wood Grain Dash Treatment	
Front Cab Carpet Package with Custom Floor mats	
-- Includes (1)	1
Remove Front Pass. Seat and Add Steel Luggage Rack	
Between	1

**Electronics**

22" LED Automotive TV with Vinyl Wrapped TV Bar 2- HDMI Ports  
**32" LED Automotive TV with 1/4 Front Wall with Black Gloss TV Surround 2- HDMI Ports**      1  
 Upgrade Front Dash Stereo DBL Din Touch Screen AM/FM, DVD,CD,IPOD,MP3,USB (GPS)  
 Satellite Radio (Sirius) Dash Stereo  
 Advanced Premium Sound System 1- 10" Subwoofer/ 1000 watt Amp  
 Rear 3rd Break Light Back up Camera with Visual Ability on front Touch Screen Stereo  
 Complete Microphone System Plays through Stereo with wireless Microphone  
 Pure sine 1000watt Inverter with 4- 110 Individual Outlets on Driver Side Wall  
  
 KVH A-9 High Def Digital Satellite Directional TV System With **DIRECT TV** Receiver (NOT HIGH DEF)\* **Please note: This item has only a 1-Year Factory Warranty and is not covered by Battisti Custom's Standard Warranty**  
  
 KVH A-9 High Def Digital Satellite Directional TV System With **DISH NETWORK** High Def Receiver \*  
**Please note: This item has only a 1-Year Factory Warranty and is not covered by Battisti Custom's Standard Warranty**  
  
 Remote Start to Work on Factory Mercedes Key-Fob  
 Viper Smart Start Security w/ App Remote Start and Kill Switch  
 Wired Remote to Rear Stereo  
 Rear Stereo DBL Din Touch Screen AM/FM, BT, DVD,CD,IPOD,MP3,USB

**Mobile Intergrated Technology**

**Apple TV System:** Will Not Stream Internet Unless Wireless Internet Option is Selected

**Crestron Electrical System:** The IPAD Supplied will be programed to operate the functions of the vehicle such as: Interior Floor, Ceiling, Indirect lighting, / Power Partition / Rear Air & Heat Function, Ect... Standard CPU with Relay Electrical System will still be installed with labeled simple function buttons. If customer has additional IPAD's that they would like connected to CRESTRON BC will program at no additional charge and add customers current Apple ID.  
NOTES: Includes Apple TV and Customer must supply Apple ID information to be installed on Ipad.

**IPAD 2nd CONTROLL**

FUNCTION: This option will add another IPAD to the Vehicle for 2nd passenger control or driver control of Crestron System.

**WIRELESS INTERNET**

FUNCTION: To provide vehicle with wireless internet up to 14 connections through wireless phone company. System is to provide best mobile service possible while vehicle is in motion.

NOTE: Customer must choose (Verizon or AT&T) as Internet service provider & Customer also must set up service to this product.

Includes:

SIERRA WIRELESS MODEM (Verizon or AT&T)

Air/Heat System	
Larger AC/Heat Free Blow Evaporator to Increase System to 66,000 BTU with rear wall pattern that matches evap blower location to louver location	1
2nd Digital Air/Heat System Control Panel	

Ceiling	
Mirror Stainless Ceiling with 500 Points of Fiber Optic Lighting and Fiber Rope Lighting on Upper Valances	

Rear Interior	
Genfloor Sound Dampening Upgraded Coach Flooring <i>(Color&amp;Style MUST be chosen in Customer Preferences Section)</i>	1
Black Snap in Removable Rear Carpet Runner	
Pleated Night Shades Fabric Match all Rear Windows	1
Remove Rear Partition Wall	
Cup Holder Package--Includes (7) Flip-Down Wall Mount Holders High Gloss Package includes:	
6" Valance Accents / 2" Pillar Inserts / 12" Ceiling Center / TV Surr	
(5) Lighted Acrylic Blue LED Grab Handles above Wood Valances	
Chrome Directional LED Reading Lights Package--Includes (7) LED Lights	

Seating	
18" Chairmen Single Rigid Seat 3-point Belt/Map Pocket/Ultra Soft Vinyl	12
10 Chairmen Single Seat 3-point Belt/Recliner/Map Pocket/Ultra Soft Vinyl <i>(Seat Next to Sliding Door)</i>	1

Exterior	
Back Up Sensors (Alerts Driver when rear of vehicle is close to an object)	1
Back Up Alarm (Alarm Makes Noise when in Reverse to make pedestrians aware)	1
Roof Escape Hatch	1
Rear Hitch w/ Wiring Package ( Sprinter has 5,000lbs Towing Capacity)	
Fiberglass Wide Step Running Board Upgrade w/Factory Paint Match and Step Treads	1
Rear Exterior Opera Lights- 3 per Side	
BC-2 Front Bumper Cover Color Code to Match with 4" Round Fog lights	
Painted Exterior Moldings - Color-Keyed to Match Paint	
Full Exterior Color Paint Change	
3500 Polished Aluminum Alcoa Wheel Upgrade	
INT DOOR EXHAUST DOOR	

Customer Preferences	
Seat Style: Chairmen 2000 Bentley - G2	
Stitching: Grey	
Seat Color: Black with Charcoal Suede Center Strip	
Indirect Lighting: Blue	
Wood Color: Black Gloss	
Interior Color: Black	
Accent Color: Charcoal Suede	
Floor Color: Red Wood	
<b>NOTE 38-5S</b>	If Carpet Runner Option Is Chosen: Wood Floors Have Snaps in Carpet Runner/Carpet Floors Have No Snaps in Carpet Runner.