

Business
Contact
Address
Phone
Fax
Email

Order Date
Due Date

Conversion Standard SLE-170 Executive Transport
Chassis 2015 3500 Mercedes Sprinter 170E
BC#
VIN#

14159



WWW.BCSPRINTER.COM
2994 Paul Drive Elkhart, IN 46514
Phone: 574-262-5466 Fax: 574-206-0024

3500 Executive Transport Floor Plan

Seating Configurations

- (5) Chairmen 2000 Denali Style Seats with Ultra Soft Touch Material
- (6) Passenger Denali Style 'L' Bench

ADD LOWER WALL LEDGE TO LEFT OF DOOR SIDE SEAT

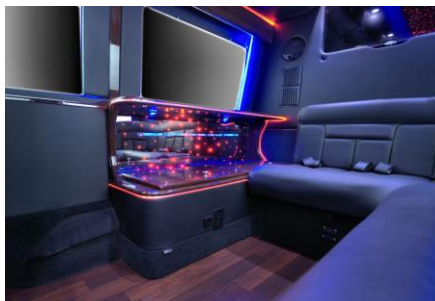
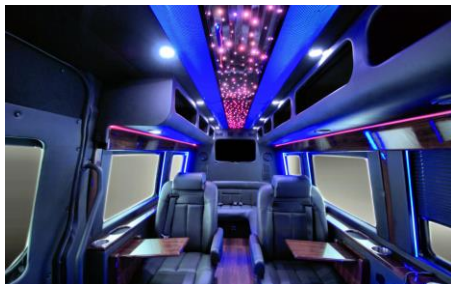
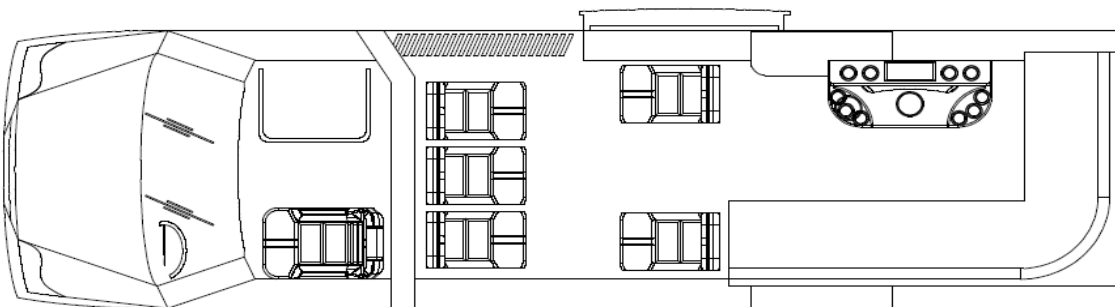

3500 Interior Executive Transport Standard Features

Walls/Valance

Complete Insulation Package Includes: Ceiling / Walls / Doors
Rolled Valance with Burl wood Accent w/ Fiber Optic Rope Lighting and Indirect white LED Lighting
5- Lighted Acrylic Grab Handles
Vinyl Wrapped Pillars with Burl wood Center Accents
Vinyl Wrapped Lower Walls with Burl wood Tops and Stainless Glass Holders
Vinyl Wrapped Rear Wall with AC Vents and Burl Wood Accent Panel
Custom Privacy Shades Package
Under Sofa Drawer Storage and Under Seating Floor lights

Ceiling

Center Burl wood Ceiling Panel w/ 10 Magnified LED puck lights, Fiber Optic Back lighting and Fiber Optic Rope Lighting

Partitions

Vinyl Wrapped Front Wall Power Partition w/ 32" TV
24" Rear Luggage Area with 2 Coat Hangers and Overhead Light Gray Trunk Liner Walls

Flooring

Black High Density Sound Damping Coach Flooring
Black Snap on and Removable Carpet Runner

Tables/Consoles

Vinyl wrapped Rear Console Between Executive Seating with Cooler, Fiber Optic Rope Lighting
HDMI Port, and 12v Power Point

Vinyl wrapped Bar with 2 Burl wood Tops, 6 cup holders, 9 flute glass holders, Mirrored Stainless
back with 200 Points of Fiber Optic and Fiber Rope Lighting 2- 24 Can Coolers

Electronics

Complete Electrical System with CPU and 2 Relay Boards
32" TV
1000watt Amp
10" Subwoofer
4 - 2 way 6.5" Speakers
Rear Backup Camera with Monitor
Front Touch Screen Double Din Stereo with CD/ Bluetooth / iPod / MP3 / AM/FM and Rear Camera Visual
Rear Touch Screen Double Din Stereo with CD/ Bluetooth / iPod / MP3 / AM/FM
Intercom System

Air/Heat System

46,000 BTU Air/Heat System with 2nd Compressor and Rear Digital Controls

Exterior Listing

Ground FX

Fiberglass Wide Step Running Boards with Factory Paint Match and Step Treads
Emergency Egress Driver Side Escape Window

**Chassis
2015**

**3500 Mercedes Sprinter 170 Extended
Jet Black Exterior**

16" Aluminum Mercedes Wheels
Power Mirrors / Cruise / PW / PL
Mercedes Badging Package with Chrome Trim Grill
2nd Factory Battery
Factory High Idle
Windows Package with Limo Tint
Aux Bracket for 2nd Compressor
FACTORY GVWR 3500: 11030

2500 Executive Transport Options

Front Cab

Price

Qty

Selected Option

Remove Front Seat add Small Luggage Rack to factory seat base mounts

1

Electronics

32" LED TV Mounted in rear wall
KVH Digital Satellite Directional TV System (Direct TV)

1

Please note: This item has only a 1-Year Factory Warranty and is not covered by Battisti Custom's Standard Warranty

1

1000watt Puresine Inverter with 2-110 Outlets

1

Mobile Intergrated Technology

WIRELESS INTERNET

FUNCTION: To provide vehicle with wireless internet up to 14 connections through wireless phone company. System is to provide best mobile service possible while vehicle is in motion.

VERIZON

NOTE: Customer must choose (Verizon or AT&T) as Internet service provider & Customer also must set up service to this product.

1

Includes:
SIERRA WIRELESS MODEM (Verizon or AT&T)

Rear Interior

Lower Wall Fold Out Laptop Tables with Burl Wood Top Each	2
---	---

Exterior

Custom Options

LOWES FLOORING	Laminate Wood Floor Dark Walnut Make Match Upper Wood Kit SEE PART NUMBER	1
	Chairmen 2000 Denali Seats 18"	5
	2 Seats with Slide Tracks for More Recline	2
	Overhead Valance Open Storage Compartments	1
	Middle Seats Have Swivel Seat Bases	2
	Stainless Mirror Ceiling (See attached pictures)	1
	Rear Wall with under rear seat open storage when rear doors are open	1

Customer Preferences

- Seat Style: Bentley Style Seating
- Seat Color: Black
- Stitching: Black
- Indirect Lighting: Blue
- Wood Color: Dark Walnut
- Interior Color: Black
- Accent Color: Black
- Floor: Dark Walnut Real LAMINATE FLOORING LOWES (CLEARWATER CL070-42) THIS PRODUCT HAS 2-3week lead-time